



STEEL FILTERS

Manual steel
screen filter

MASTERS OF FILTRATION



Anywhere



Any Water Source



Any Technology

**Farming is
our heritage.**
**Filtration is our
legacy.**

At Amiad, our roots are in the land. As farmers, we learned at firsthand what our crops need to thrive. We understand that every water source is different, and how water quality can greatly affect crop yield.

The filter is the first vital link in the irrigation chain. It's there to protect irrigation systems from damage, while delivering the best quality water.

We develop filters that are able to cope with any water quality, in any geographical location.

We've spent years mastering filtration technology so we can offer a wide range of filters for every farmer's needs including screen, disc or media technology. Our fully automated filtration systems save time, manpower and costs.

We consider every challenge as an opportunity to work side by side with our customers to solve their problems. We'll go anywhere to ensure our filters perform as expected, 24/7, every day of the year.

When you want a high performance filter for your irrigation system, consult with Amiad. We focus on doing what we do best.

Amiad. Masters of Filtration.



Disc
Technology



Screen
Technology



Media
Technology

Steel Filters: Models

2" in-line

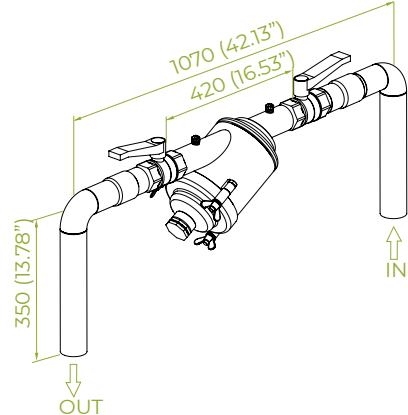
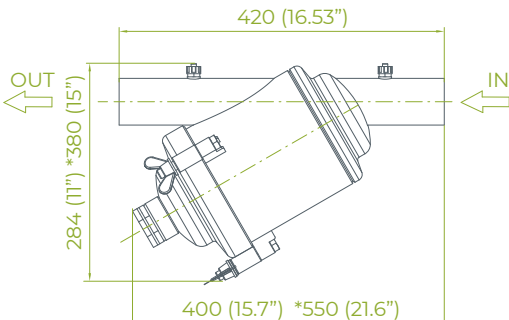

Pressure Loss Graphs (in clean water)

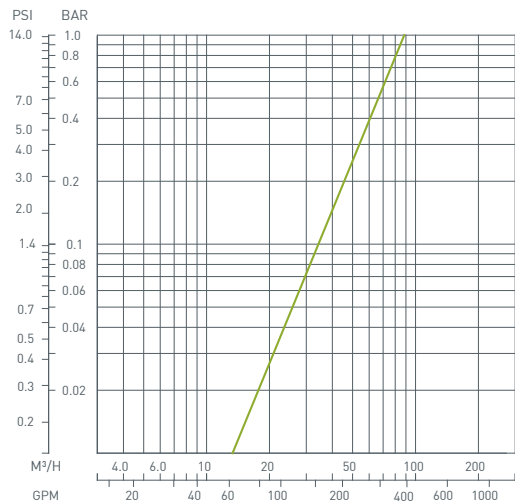

3" in-line

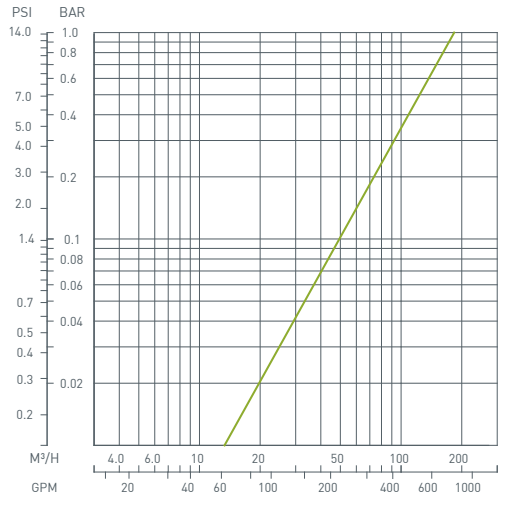
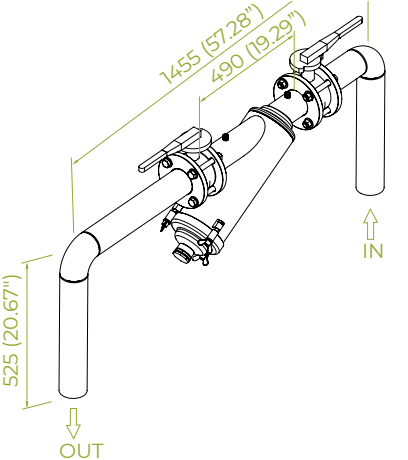
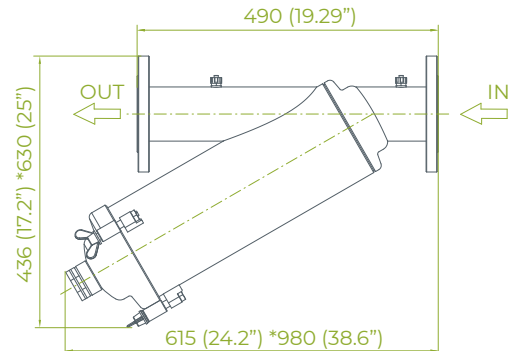

4" Compact in-line

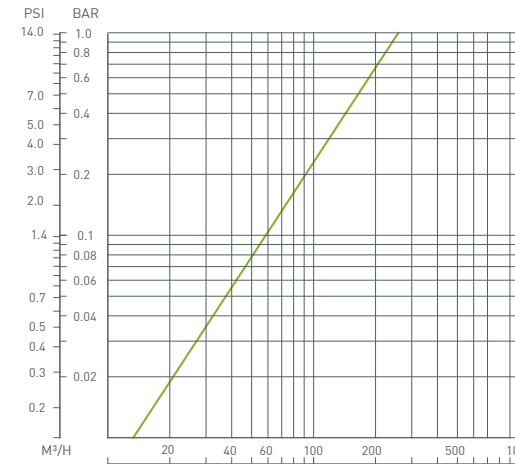
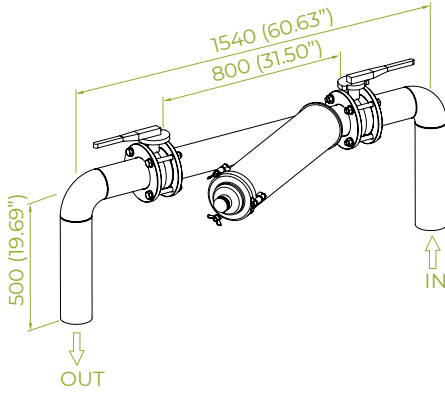
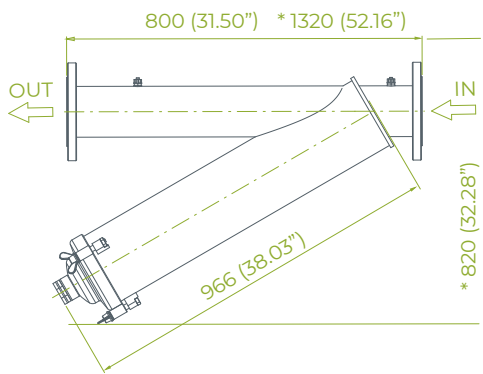

Dim: mm (inch)
*Approx. length required for maintenance

Dim: mm (inch)

Steel Filters: Models



4" Super in-line | 6" Compact

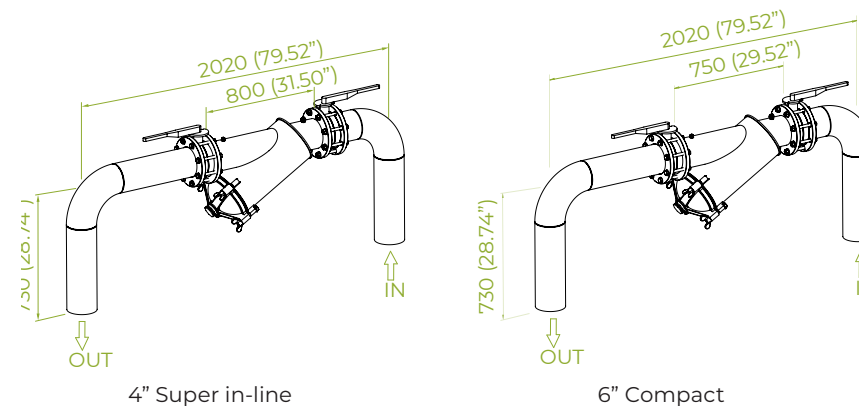
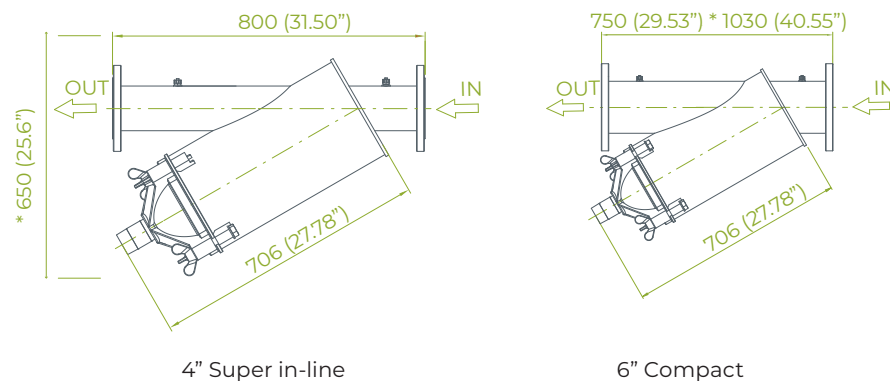

Pressure Loss Graphs (in clean water)

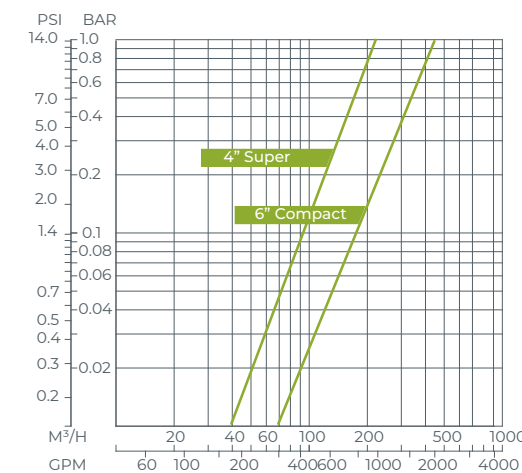

6" Super in-line | 8" in-line

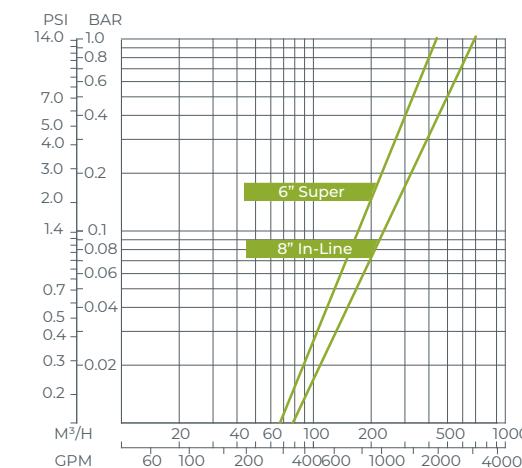
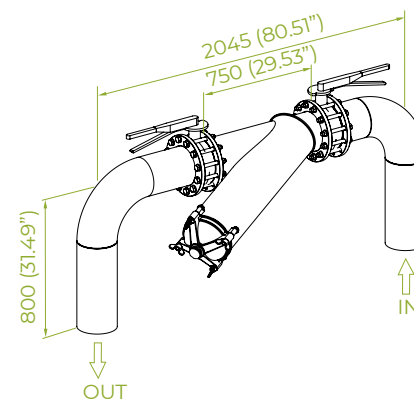
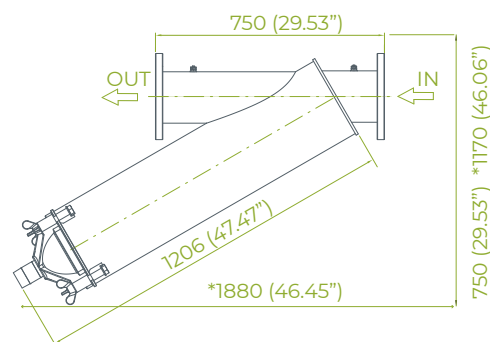

6" Super modular | 8" modular

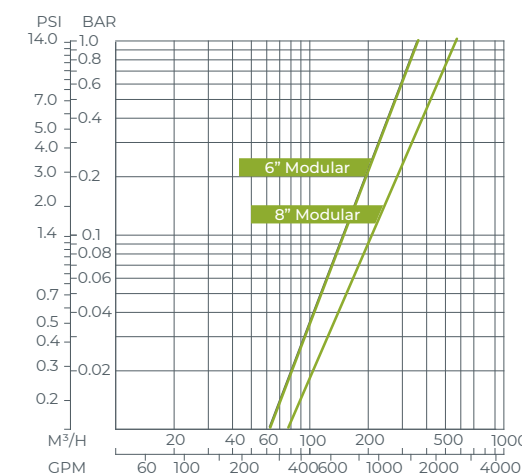
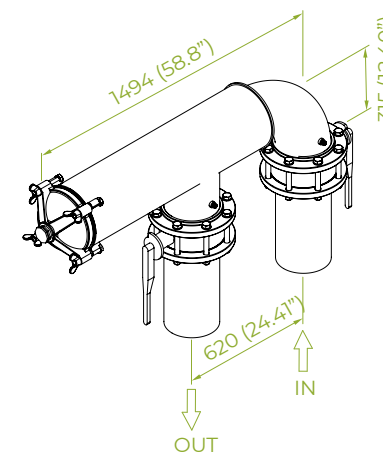
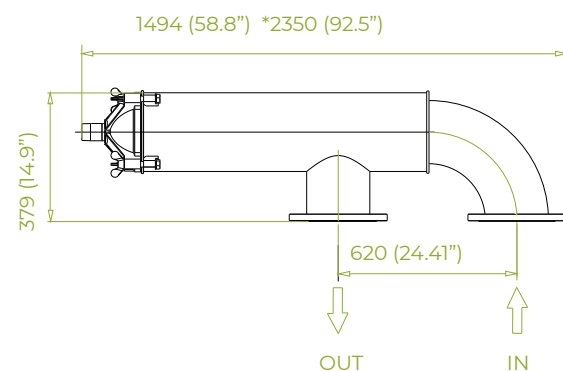

Dim: mm (inch)

*Approx. length required for maintenance

Dim: mm (inch)

Steel Filters: Models

Technical Specifications

Filter Type	2" In-Line	3" In-Line
General Data		
Maximum flow rate*	25 m ³ /h (110 gpm)	50 m ³ /h (220 gpm)
Inlet/outlet diameter flanges and threads	50 mm (2")	80 mm (3")
Standard filtration degrees	3500, 2500, 1500, 800, 500, 300, 200, 130, 100, 80 micron	
Max. operating pressure	10 bar (145 psi)	
Max. operating temperature	60°C (140°F)	
Drain port	40 mm (1 ½") plugged	
Weight [empty] threaded	7.3 kg (16 lbs)	13.6 kg (30 lbs)
Weight [empty] flanged	10.5 kg (23 lbs)	16.6 kg (36.6 lbs)

Filter Type	4" Compact In-Line	4" Super In-Line	6" Compact In-Line
General Data			
Maximum flow rate*	80 m ³ /h (352 gpm)	100 m ³ /h (440 gpm)	160 m ³ /h (704 gpm)
Inlet/outlet diameter	100 mm (4")		150 mm (6")
Standard filtration degrees	3500, 2500, 1500, 800, 500, 300, 200, 130, 100, 80 micron		
Max. operating pressure	10 bar (145 psi)		
Max. operating temperature	60°C (140°F)		
Drain port	40mm (1 ½") plugged	50 mm (2") unplugged	
Weight [empty] flanges	27.5 kg (60.6 lbs)	38 kg (83.7 lbs)	43 kg (94.7 lbs)

Filter Type	6" Super In-Line/Modular	8" In-Line/Modular
General Data		
Maximum flow rate*	160 m ³ /h (704 gpm)	300 m ³ /h (1,320 gpm)
Inlet/outlet diameter	150 mm (6")	200 mm (8")
Standard filtration degrees	3500, 2500, 1500, 800, 500, 300, 200, 130, 100, 80 micron	
Max. operating pressure	10 bar (145 psi)	
Max. operating temperature	60°C (140°F)	
Drain port	50 mm (2") unplugged	
Weight [empty]	56 kg (123.4 lbs)	65 kg (143.2 lbs)

* Consult Amiad for optimum flow depending on filtration degree & water quality.

Engineering Data

Filter Type	2" In-Line	3" In-Line
Filter Element Data		
Filtration area	800 cm ² (124 in ²)	1,600 cm ² (248 in ²)
Filter element types	Weavewire screen, perforated screen	

Construction Materials*	
Filter housing	Carbon steel 37-2 with polyester coating
Filter lid	Carbon steel 37-2 with polyester coating
Seals	NBR
Weavewire screen	Polypropylene + glass fibers, stainless steel
Perforated screen	Stainless steel 316

Filter Type	4" Compact In-Line	4" Super In-Line	6" Compact In-Line
Filter Element Data			
Filtration area	2,400 cm ² (372 in ²)	2,800 cm ² (434 in ²)	2,800 cm ² (434 in ²)
Filter element types	Weavewire screen, perforated screen		

Construction Materials*		
Filter housing	Carbon steel 37-2 with polyester coating	SMC polyester
Filter lid	NBR	
Seals	Carbon steel 37-2 with polyester coating	
Weavewire screen	Stainless steel 316 with polypropylene + fiber glass and NBR seals	
Perforated screen	Stainless steel 316 and NBR seals	

Filter Type	6" Super In-Line/Modular	8" In-Line/Modular
Screen Data		
Filtration area	5,800cm ² (899 in ²)	
Filter element types	Weavewire screen, perforated screen	

Construction Materials*	
Filter housing	Carbon steel 37-2 with polyester coating
Filter lid	SMC polyester
Seals	NBR
Weavewire screen	Stainless steel 316 with polypropylene + fiber glass and NBR seals
Perforated screen	Stainless steel 316 and NBR seals

* Amiad offers a variety of construction materials. Consult us for specifications.



Headquarters

Amiad Water Systems Ltd.

Web: www.amiad.com
E-mail: info@amiad.com

The Americas

USA

Amiad USA Inc.

Web: us.amiad.com | E-mail: infousa@amiad.com

Mexico

Amiad México SA DE CV,

Web: es.amiad.com | E-mail: infomexico@amiad.com
Irrigation office: E-mail: infomexico-irr@amiad.com

Asia

India

Amiad Filtration India Pvt Limited

Web: amiad.com | E-mail: info-india@amiad.com

China

Amiad China (Yixing Taixing Environtec Co., Ltd.)

Web: cn.amiad.com | E-mail: infochina@amiad.com

South-East Asia

Filtration & Control Systems Pte. Ltd.

Web: amiad.com | E-mail: info-singapore@amiad.com

Australia

Amiad Australia Pty Ltd.

Web: au.amiad.com | E-mail: sales@amiad.com

Europe

France

Amiad Water Systems Europe SAS

Web: fr.amiad.com

German branch office

Web: de.amiad.com

Amiad Water Systems UK Limited

Web: amiad.com | E-mail: info-uk@amiad.com



 **amiad** IRRIGATION

MASTERS OF FILTRATION

www.amiad.com

910101-000386/05.2022

Copyright © 2019 Amiad Water Systems Ltd. All rights reserved. The contents of this catalogue including without limitation all information and materials, images, illustrations, designs, icons, photographs, graphical presentations, designs, literary works, data, drawings, slogans, phrases, names, trademarks, titles and any other such materials that appear in this catalogue (collectively, the "Contents") are the sole property of Amiad Water Systems Ltd. ("Amiad"). Amiad has sole and exclusive right, title and interest in the Contents, including any intellectual property rights, whether registered or not, and all know-how contained or embodied therein. You may not reproduce, publish, transmit, distribute, display, modify, create derivative works from, sell or participate in any sale of, or exploit in any way, in whole or in part, any of the Contents or the catalogue. Any use of the catalogue or the Contents, other than for personal use, requires the advanced written permission of Amiad.